

SG Series

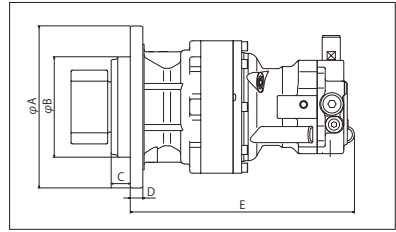

[Main Application]

- Swing unit with reducer for various construction machines such as hydraulic excavators

Rated output torque [kN-m]



[Features]

- Lightweight, compact, low-noise motor with excellent micro-operability
- Floating valve plate structure with high efficiency and excellent self-priming performance

■ Specification

		SG02H	SG025E	SG04G	SG06G	SG08G	SG25E
Rated Output Torque	N-m	2000	3200	4900	5500	12000	22300
Max. Pressure	MPa	20.5	23	27.9	27.9	29.4	25.5
Max. Flow Rate (ref.)	L/min	44	80	140	105	220	360
Applicable Excavator Weight (ref.)	ton	6~7	7~8	8~12	12~16	16~25	30~

■ Optional Functions

	SG02H	SG025E	SG04G	SG06G	SG08G	SG25E
Anti-swing-back	✓	✓	✓	✓	✓	✓
Shock-less Relief	✓	✓	✓	✓	✓	✓
Super Shock-less Relief	-	✓	✓	✓	✓	✓
Time Delay Valve	✓	✓	✓	✓	✓	✓

✓ : Available

■ Outline Dimensions

		SG02H	SG025E	SG04G	SG06G	SG08G	SG25E
A	mm	255	288	323	323	410	480
B	mm	175	200	200	200	310	350
C	mm	22	31.5	38	38	54	64.5
D	mm	20	20	25	25	30	35
E	mm	261	397	432.5	442.5	606	798.5

CS Series

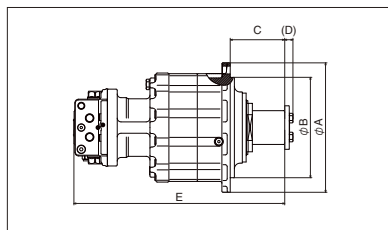

[Main Application]

- Slewing units with reducer for cranes, elevated work vehicles, mining equipment, etc.

[Features]

- Supports feed and swivel
- Compact shaft rotation motor
- Built-in parking brake
- 2-speed motor (high/low speed)

Rated output torque [kN-m]



■ Specification

		CS04	CS05A	CS09B
Rated Output Torque	N-m	2940	3920	8630
Max. Output Speed	min-1	60	56	60
Max. Pressure	MPa	24.5	20.6	31.4
Max. Flow Rate (ref.)	L/min	51	73	97

■ Outline Dimensions

		CS04	CS05A	CS09B
A	mm	280	306	342
B	mm	175	230	265
C	mm	104	120	144
(D)	mm	19	20	22
E	mm	405	408	533.5

MFD/MFC Series



[Main Application]

- Swing motors for various construction machines such as hydraulic excavators

[Features]

- Lightweight, compact, low-noise motor with excellent micro-operability
- Floating valve plate structure with high efficiency and excellent self-priming performance

■ Specification

		MFD30	MFC40	MFD80	MFD140	MFC160	MFC200	MFC250
Max. Motor Displacement	cm ³ /rev	27	45	80	131	151	187	250
Max. Pressure	MPa	20.5	24.5	27.9	29.4	29.4	29.4	29.4
Max. Flow Rate (ref.)	L/min	40	80	130	220	220	290	360